

NEXSTAND K2

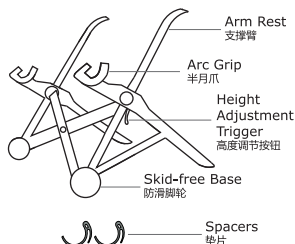

Compact Light Weight Design
轻盈、便携

Supports Almost All Popular Laptops
适配所有主流笔记本电脑

Features 7 Height Adjustment Options
7档高度可调

Engineered for Stability and Durability
坚固、稳定

Ergonomically Designed
人体工学设计

Natural Airflow Cooling
自然风散热

Made of Durable Components for Years of Dependable Use
经久耐用

Although possible to adjust stand height with laptop in place, it is recommended to remove laptop before attempting any height adjustments.

虽然笔记本电脑放置在支架上时也可以调节支架高度，但建议您调节高度时先取下笔记本电脑。

Correct hand placement on Skid-free Base will avoid unintentional fingerpinching with closure of stand. 收起支架时，小心手指不要被夹。

©2016 HIGH NICHE. All rights reserved. Made in China

Nexstand is a registered trademark of High Niche. All rights are reserved. No reproduction in any form or by any means without written permission from High Niche.

Manufactured by: Shanghai Puhe Mold Co., Ltd.
Supervised by: Shanghai High Niche Investment Co., Ltd.
Add.: No.29, Jia Tai Road, China(Shanghai) Pilot Free Trade Zone, CN

Patents Pending
专利申请中

I Expand Stand

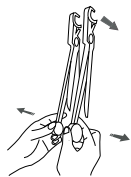

IV Height Adjustment-Up

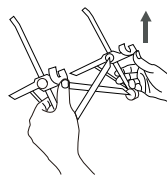

II Close Stand

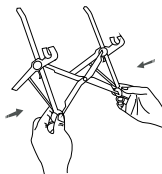

IV Placement



III Height Adjustment-Down

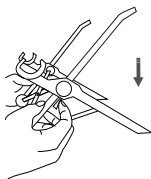

VI Spacer (Optional)

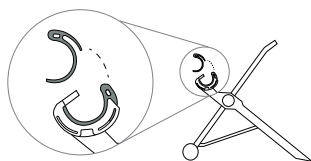

1 打开支架

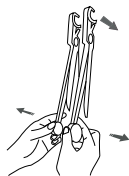

双手捏住防滑脚轮，使半月爪的凹口朝下。向外侧拉动防滑脚轮，打开支架，并将支架置于平面上。

4 提升高度

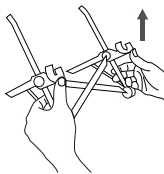

拇指上推半月爪，即可将高度升高。调高时无需按压高度调节按钮。

2 收起支架

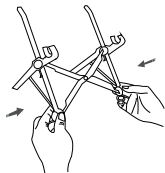

双手指尖捏住防滑脚轮，向内侧收拢至闭合状态即可。

5 固定笔记本



将笔记本前边缘插入半月爪，然后顺势将笔记本停靠于支撑臂上。

3 降低高度

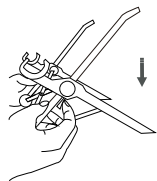

按下高度调节按钮的同时，稍用力下压支撑臂，支架高度即可调低。调整到适宜高度后，松开高度调节按钮以锁定支架。

6 垫片（选择性使用）

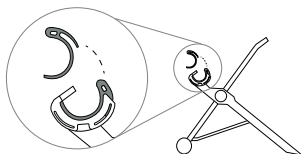

将垫片嵌入半月爪内，即可适配部分超薄和超轻笔记本。大部分普通笔记本无需使用此垫片。

NEXSTAND™

K2

Compact Portable Laptop Stand
with Adjustable Height

便携、折叠、高度可调笔记本支架



www.NexStand.com